

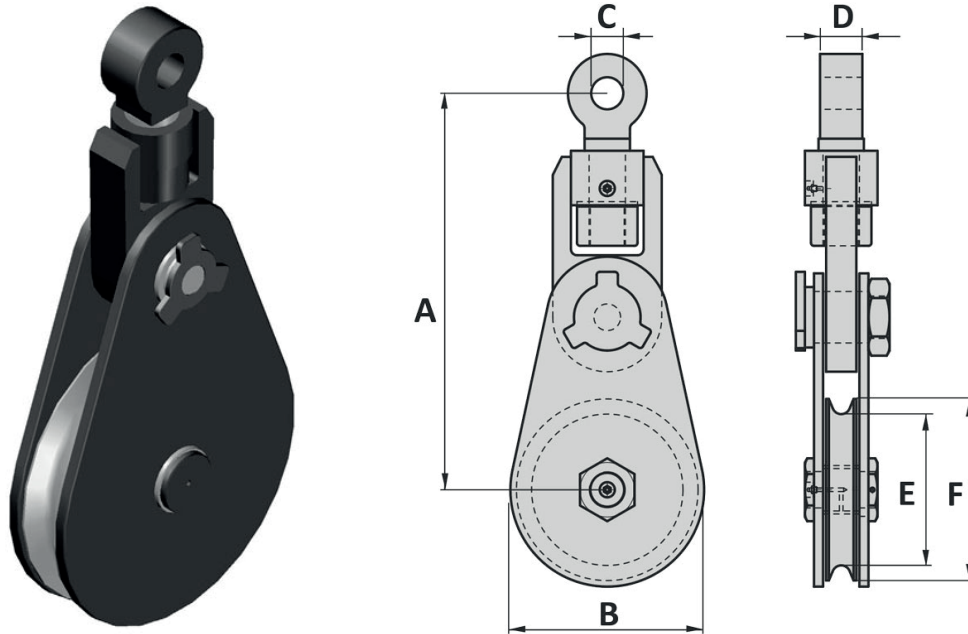

Snatch blocks

Snatch block for shackle lifting, type BL3

Groove size can be changed on request for bigger rope sizes.



- Material : mild steel
- Safety factor : 4 times
- Finish : painted
- Temperature range : -20°C up to +200°C
- Standard certification : Certificate of Conformity

- Sheaves with bronze bearing.
- Sheaves with roller bearing on request.

Art. No. Light Type	Type No.	WLL eye pull ton	WLL line pull ton	Rope size inch	Rope size mm	A mm	B mm	C mm	D mm	E mm	F mm	Weight kg
107.20041903	H41903	3.25	1.62	3/8	8 - 10	188	82	20	26	56	76	4
107.20041905	H41905	4.75	2.37	1/2	11 - 14	250	122	24	30	86	114	9
107.20041906	H41906	8.5	4.25	3/4	18 - 20	356	162	30	40	112	152	19
107.20041908	H41908	8.5	4.25	3/4	18 - 20	381	216	30	40	163	203	24
107.20041910	H41910	9.5	4.75	3/4	18 - 20	406	270	34	44	214	254	30
107.20041912	H41912	9.5	4.75	3/4	18 - 20	446	320	34	44	265	305	39
107.20041914	H41914	12	6	3/4	18 - 20	516	396	37	48	315	365	50
107.20041916	H41916	13.5	6.75	7/8	22 - 25	645	430	42	54	356	406	93
107.20041918	H41918	17	8.5	1	22 - 25	690	490	44	57	408	458	112
Heavy Type												
107.20043106	H43106	17	8.5	1	22 - 25	490	160	44	57	110	150	49
107.20043108	H43108	25	12.5	1 1/8	25 - 28	602	220	53	70	150	200	78
107.20043110	H43110	25	12.5	1 1/4	28 - 32	632	270	53	70	190	250	92
107.20043112	H43112	25	12.5	1 1/4	28 - 32	662	320	53	70	240	300	112
107.20043114	H43114	25	12.5	1 1/4	28 - 32	692	370	53	70	290	350	127

Tolerance: Forged parts ± 5%, machined parts ± 1 mm

(Important note: Measures and weights without engagement. We reserve the right to change technical details.)