

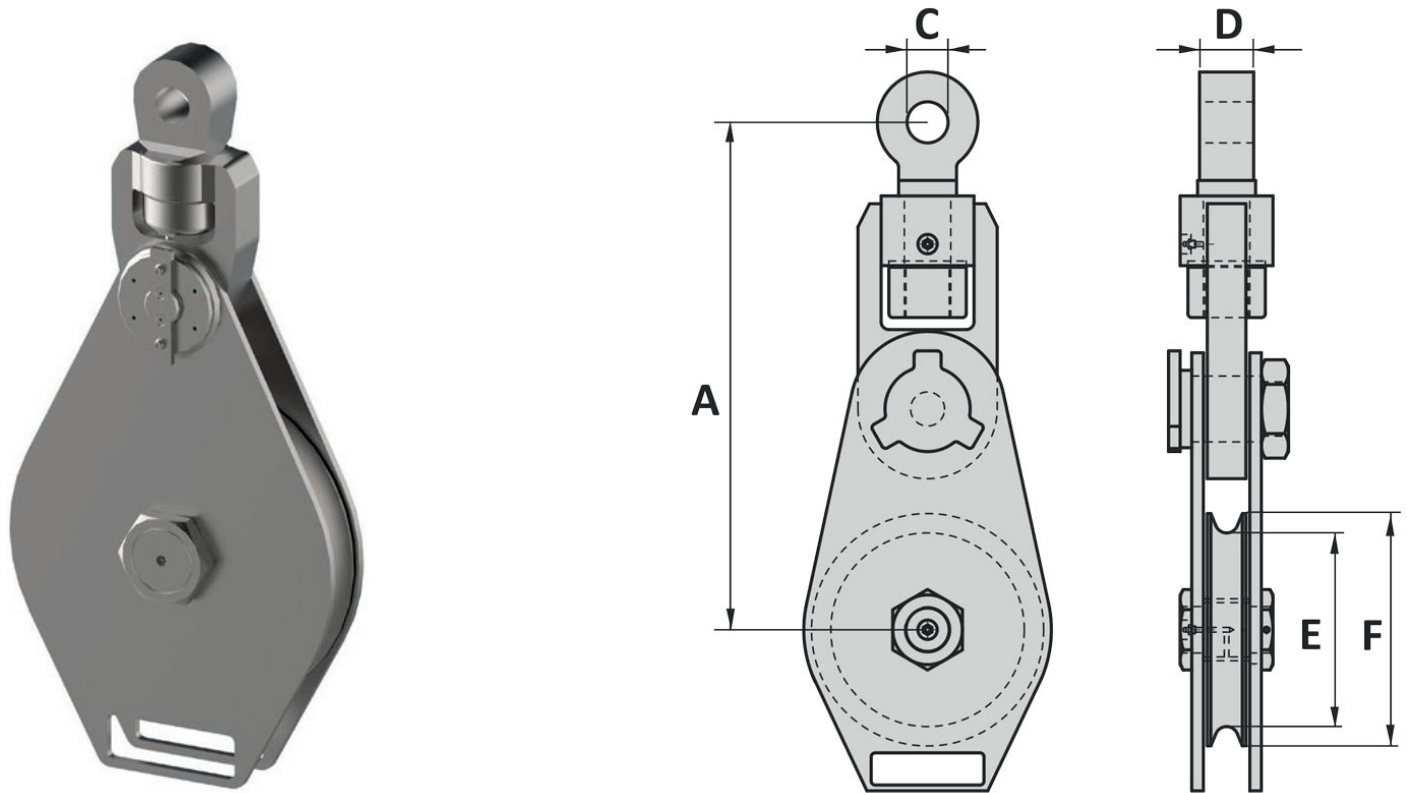

Snatch blocks

Snatch block with safety window, type BL2

Groove size can be changed on request for bigger rope sizes.



- Material : mild steel
 - Safety factor : 4 times
 - Finish : painted
 - Temperature range : -20°C up to +200°C
 - Standard certification : Certificate of Conformity
- Sheaves with bronze bearing.
 - Sheaves with roller bearing on request.

Art. No.	Type No.	WLL ton	Rope size mm	Line pull ton	A mm	C mm	D mm	E mm	F mm	Weight kg
107.20143118	SH43118	35	32 - 38	17.5	680	60	80	380	450	160
107.20143224	SH43224	55	38 - 42	27.5	850	73	100	520	605	260
107.20143230	SH43230	85	44 - 48	42.5	1020	85	120	640	760	484
107.20143234	SH43234	120	50 - 55	60	1190	100	140	740	860	740
107.20143236	SH43236	150	60 - 70	75	1320	113	160	760	910	992
107.20143242	SH43242	200	75 - 85	100	1490	135	170	870	1060	1573
107.20143246	SH43246	250	88 - 93	125	1645	145	190	970	1170	2097

Tolerance: Machined parts ± 1 mm

(Important note: Measures and weights without engagement. We reserve the right to change technical details.)