

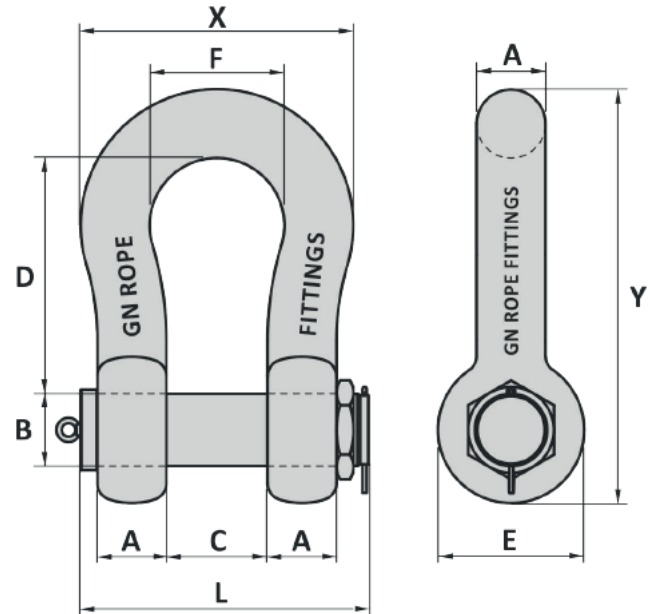

Shackles for lifting

Bow safety pin shackle, type H10

Non-standard sizes or custom products available on request



- Material : alloy steel
- Safety factor : 5x
- Standards : generally according to US Federal Spec RR-C-271
- Finish : painted
- Temperature range : -40°C up to +200°C, polar rated
- Standard certification : Certificate of Conformity and 3.1 material certificate EN 10204
- Individual dimensions and colors possible on customer request
- All H10 shackles passed the in-house proof load test

*Shackles from 1,250 ton completed with eyebolts on both sides

Art.No.	WLL ton	A mm	B mm	C mm	D mm	E mm	F mm	L mm	X mm	Y mm	Weight kg
107.37001209	120	89	95	150	380	200	238	420	416	617	110
107.37001509	150	102	108	170	400	230	275	475	479	671	160
107.37002009	200	120	125	180	500	260	290	520	530	813	235
107.37002509	250	125	140	205	540	260	305	560	555	865	285
107.37003009	300	130	150	205	600	305	305	570	565	958	340
107.37004009	400	165	175	230	680	350	325	665	655	1108	560
107.37005009	500	180	185	255	700	370	350	720	710	1158	685
107.37006009	600	195	205	285	700	405	375	815	765	1200	880
107.37007009	700	205	217	310	700	435	400	860	810	1231	980
107.37008009	800	210	217	310	700	435	400	870	820	1236	1100
107.37009009	900	220	230	330	700	465	420	910	860	1268	1280
107.37010009	1000	230	240	350	750	480	420	950	880	1290	1460
107.37012509*	1250	278	270	370	780	590	450	1105	1010	1490	2320
107.37015009*	1500	280	290	370	800	610	450	1105	1010	1530	2450
107.37017509*	1750	300	330	430	950	660	540	1230	1140	1745	3280
107.37020009*	2000	320	360	460	1050	680	560	1300	1200	1890	3920

Tolerance: Inside length ± 7.5%, all other forged parts ± 5%, machined parts Teile ± 1 mm

(Important note: Measures and weights without engagement. We reserve the right to change technical details.)